

**FASTENING DETAIL**

30W FASTEN AT EACH SUPPORT  
30W FASTEN AT EACH SUPPORT  
24W FASTEN AT EACH SUPPORT  
18W FASTEN AT EACH SUPPORT  
12W FASTEN AT EACH SUPPORT  
6W FASTEN AT EACH SUPPORT

36 (STANDARD)  
36T (STANDARD)  
36F (STANDARD)  
30 (SPECIAL)  
30T (SPECIAL)  
30F (SPECIAL)  
24 (SPECIAL)  
24T (SPECIAL)  
24F (SPECIAL)  
18T (STANDARD)  
18F (STANDARD)  
12T (STANDARD)  
12F (STANDARD)  
6T (STANDARD)  
6F (STANDARD)  
12FF (SPECIAL)

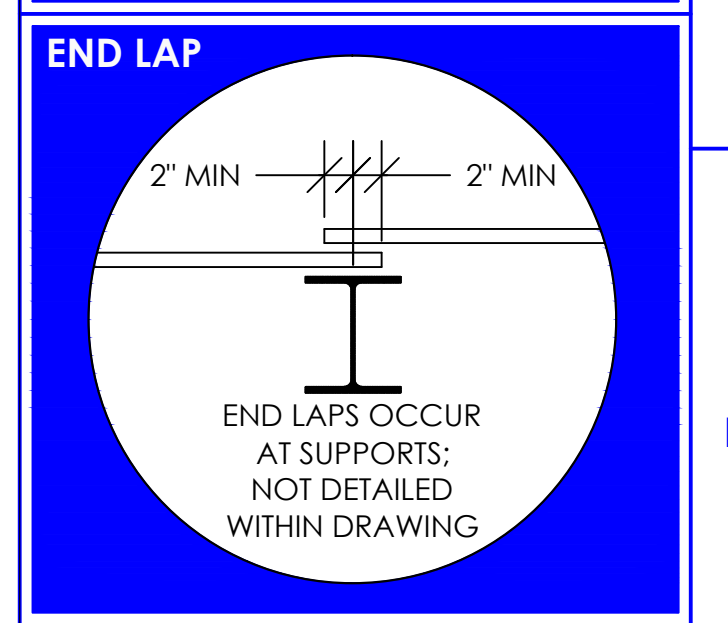
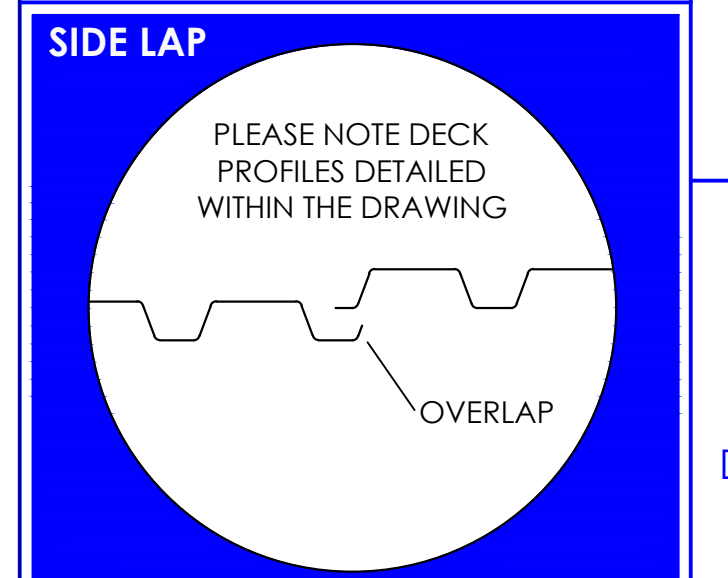

THIS DRAWING IS PROVIDED FOR THE PURPOSE OF CREATING A DECK LAYOUT OF THE FLOORING SYSTEM. SUMMIT IS GENERALLY NOT INVOLVED IN THE COMPLETE DESIGN AND IMPLEMENTATION OF THE END USER'S STORAGE SYSTEM AND THEREFORE NOT FULLY AWARE OF THE PROJECT SCOPE. IT IS THE RESPONSIBILITY OF THE CUSTOMER NOTED BELOW TO CONFIRM THAT ALL OF THE INFORMATION DETAILED IS ACCURATE. SUMMIT SHALL NOT BE RESPONSIBLE FOR ANY ERRORS, OMISSIONS, AND/OR DAMAGES RESULTING FROM THE USE OF THIS DRAWING.

THIS DRAWING IS CONFIDENTIAL AND THE PROPERTY OF SUMMIT METAL PRODUCTS. ALL INFORMATION CONTAINED HEREIN SHALL NOT BE COPIED OR DISCLOSED TO ANY OUTSIDE PARTIES WITHOUT EXPRESS WRITTEN PERMISSION FROM SUMMIT.

TITLE: SAMPLE DECK COVERAGES FOR AISLEWAYS

CUSTOMER:

DRAWING VERIFICATION: DECK TEMPLATES

PROJECT NUMBER: DATE: 2/16/2016 SHEET: 1 OF 1

	1	2	3	4	5	6	7	8	9	10
A	42.0 (36+6T)	78.0 (36+36+6T)	114.0 (36+36+36+6T)	150.0 (36+36+36+36+6T)						
B	44.5 (36+12F)	80.5 (36+36+12F)	116.5 (36+36+36+12F)	152.5 (36+36+36+36+12F)						
C	48.0 (36+12T)	84.0 (36+36+12T)	120.0 (36+36+36+12T)	156.0 (36+36+36+36+12T)						
D	50.5 (36+18F)	86.5 (36+36+18F)	122.5 (36+36+36+18F)	158.5 (36+36+36+36+18F)						
E	54.0 (36+18T)	90.0 (36+36+18T)	126.0 (36+36+36+18T)	162.0 (36+36+36+36+18T)						
F	56.5 (36+24F)	92.5 (36+36+24F)	128.5 (36+36+36+24F)	164.5 (36+36+36+36+24F)						
G	60.0 (36+24T)	96.0 (36+36+24T)	132.0 (36+36+36+24T)	168.0 (36+36+36+36+24T)						
H	62.5 (36+30F)	98.5 (36+36+30F)	134.5 (36+36+36+30F)	170.5 (36+36+36+36+30F)						
I	66.0 (36+30T)	102.0 (36+36+30T)	138.0 (36+36+36+30T)	174.0 (36+36+36+36+30T)						
J	68.5 (36+36F)	104.5 (36+36+36F)	140.5 (36+36+36+36F)	176.5 (36+36+36+36+36F)						
K	72.0 (36+36T)	108.0 (36+36+36)	144.0 (36+36+36+36)	180.0 (36+36+36+36+36)						
L	73.0 (36+36)	109.0 (36+36+36)	145.0 (36+36+36+36)	181.0 (36+36+36+36+36)						
	1	2	3	4	5	6	7	8	9	10